

DIN 1473 similar to ISO 8740

Grooved pins

Parallel grooved over full length

Steel | bright | Cr(VI)-free

Further information: DIN standard has been withdrawn

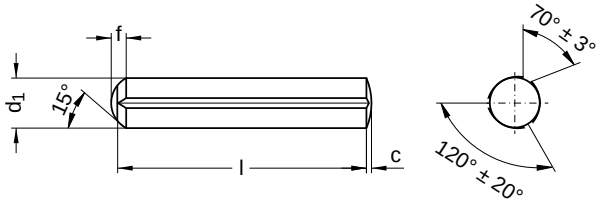

Diameter (d)	c	d ₁ nominal size	f
1.5	0.20	1.5	0.8
2	0.25	2	0.9
2.5	0.30	2.5	1.2
3	0.40	3	1.3
4	0.50	4	1.8
5	0.60	5	2.0
6	0.80	6	2.5
8	1.00	8	2.8
10	1.20	10	3.5
12	1.60	12	3.7

nominal size	Length (l)	
	min.	max.
4	3.76	4.24
5	4.76	5.24
6	5.76	6.24
8	7.71	8.29
10	9.71	10.29
12	11.65	12.35
14	13.65	14.35
16	15.65	16.35
18	17.65	18.35
20	19.58	20.42

nominal size	Length (l)	
	min.	max.
22	21.58	22.42
24	23.58	24.42
26	25.58	26.42
28	27.58	28.42
30	29.58	30.42
32	31.50	32.50
36	35.50	36.50
40	39.50	40.50
45	44.50	45.50
50	49.50	50.50

nominal size	Length (l)	
	min.	max.
55	54.40	55.60
60	59.40	60.60
65	64.40	65.60
70	69.40	70.60
80	79.40	80.60
90	89.30	90.70
100	99.30	100.70
110	109.30	110.70
120	119.30	120.70

All technical data refer to the measure mm



DIN 1473 similar to ISO 8740

Grooved pins

Parallel grooved over full length

Steel | bright | Cr(VI)-free

Diameter (d)	Length (l)																													
	4	5	6	8	10	12	14	16	18	20	22	24	26	28	30	32	36	40	45	50	55	60	65	70	80	90	100	110	120	
1.5	●	●	●		●	●	●	●	●	●																				
2	●	●	●	●	●	●	●	●	●	●	●	●	●	●	●															
2.5			●	●	●	●	●	●	●	●	●	●	●	●	●															
3			●	●	●	●	●	●	●	●	●	●	●	●	●															
4			●	●	●	●	●	●	●	●	●	●	●	●	●	●	●	●	●	●	●									
5				●	●	●	●	●	●	●	●	●	●	●	●	●	●	●	●	●	●	●								
6					●	●	●	●	●	●	●	●	●	●	●	●	●	●	●	●	●	●	●							
8							●	●	●	●	●	●	●	●	●	●	●	●	●	●	●	●	●	●	●	●	●	●	●	●
10								●	●	●	●	●		●	●	●	●	●	●	●	●	●	●	●	●	●	●	●	●	
12									●	●	●	●		●	●	●	●	●	●	●	●	●	●	●	●	●	●	●	●	

• Combinations available in the eShop | Other sizes on request

All technical data refer to the measure mm

