

**DIN 1479**

**Turnbuckle sleeves**

Made from hexagon steel

Steel | zinc-plated | Cr(VI)-free | Metric thread

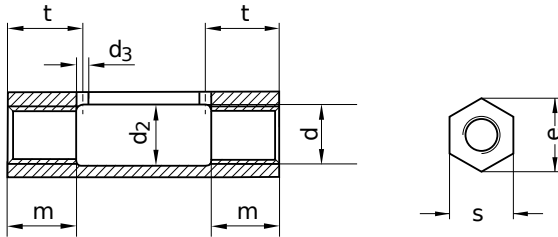

Diameter (d)	d <sub>2</sub> nominal size	d <sub>3</sub>			m	e min.	s	
		nominal size	min.	max.			min.	max.
M6	-	4	3.7	4.3	22.5	11.05	9.78	10
M8	-	4	3.7	4.3	25.0	14.38	12.73	13
M10	-	4	3.7	4.3	33.0	17.77	15.73	16
M12	-	4	3.7	4.3	40.0	20.03	17.73	18
M16	-	4	3.7	4.3	55.0	26.75	23.67	24
M20	21	4	3.7	4.3	24.0	32.95	29.16	30
M24	26	4	3.7	4.3	29.0	39.55	35.00	36
M30	32	4	3.7	4.3	36.0	50.86	45.00	46

Diameter (d)	Pitch (P)	t nominal size	Tool size	Length (l)		
				nominal size	min.	max.
M6	1.00	9.5	SW 10	30	29.5	30.5
M8	1.25	12.0	SW 13	35	34.2	35.8
M10	1.50	14.0	SW 16	45	44.2	45.8
M12	1.75	17.0	SW 18	55	54.2	55.8
M16	2.00	22.0	SW 24	75	74.2	75.8
M20	2.50	26.0	SW 30	95	94.2	95.8
M24	3.00	31.0	SW 36	115	114.2	115.8
M30	3.50	38.0	SW 46	125	123.8	126.2

All technical data refer to the measure mm

