

DIN 94 similar to ISO 1234

Split pins

Threaded end $\approx 1,25 d$

Steel | zinc-plated | Cr(VI)-free

Further information: DIN-standard has been withdrawn

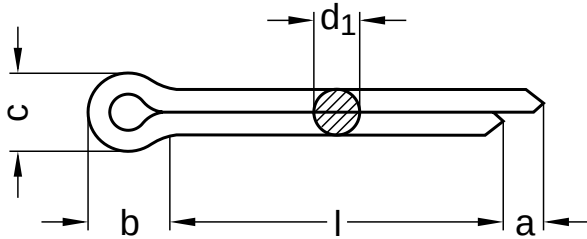

Diameter (d)	a		b nominal size	c		nominal size	d ₁	
	min.	max.		min.	max.		min.	max.
1	0.80	1.6	3.0	1.6	1.8	1	0.8	0.9
1.6	1.25	2.5	3.2	2.4	2.8	1.6	1.3	1.4
2	1.25	2.5	4.0	3.2	3.6	2	1.7	1.8
2.5	1.25	2.5	5.0	4.0	4.6	2.5	2.1	2.3
3.2	1.60	3.2	6.4	5.1	5.8	3.2	2.7	2.9
4	2.00	4.0	8.0	6.5	7.4	4	3.5	3.7
5	2.00	4.0	10.0	8.0	9.2	5	4.4	4.6
6.3	2.00	4.0	12.6	10.3	11.8	6.3	5.7	5.9
8	2.00	4.0	16.0	13.1	15.0	8	7.3	7.5
10	3.20	6.3	20.0	16.6	19.0	10	9.3	9.5
13	3.20	6.3	26.0	21.7	24.8	13	12.1	12.4

nominal size	Length (l)	
	min.	max.
6	5.40	6.60
8	7.25	8.75
10	9.25	10.75
12	11.10	12.90
14	13.10	14.90
16	15.10	16.90
18	17.10	18.90
20	19.00	21.00
22	21.00	23.00
25	24.00	26.00

nominal size	Length (l)	
	min.	max.
28	27.00	29.00
32	30.75	33.25
36	34.75	37.25
40	38.75	41.25
45	43.75	46.25
50	48.75	51.25
56	54.50	57.50
63	61.50	64.50
71	69.50	72.50
80	78.50	81.50

nominal size	Length (l)	
	min.	max.
90	88.25	91.75
100	98.25	101.75
112	110.25	113.75
125	123.00	127.00
140	138.00	142.00

All technical data refer to the measure mm



DIN 94 similar to ISO 1234

Split pins

Threaded end $\approx 1,25 d$

Steel | zinc-plated | Cr(VI)-free

Diameter (d)	Length (l)																									
	6	8	10	12	14	16	18	20	22	25	28	32	36	40	45	50	56	63	71	80	90	100	112	125	140	
1	●	●	●	●	●	●	●																			
1.6		●	●	●	●	●	●	●	●	●	●	●														
2			●	●	●	●	●	●	●	●	●	●	●	●												
2.5				●	●	●	●	●	●	●	●	●	●	●	●	●										
3.2						●	●	●	●	●	●	●	●	●	●	●	●	●								
4								●	●	●	●	●	●	●	●	●	●	●	●	●	●					
5									●	●	●	●	●	●	●	●	●	●	●	●	●	●				
6.3												●	●	●	●	●	●	●	●	●	●	●	●	●	●	●
8														●	●	●	●	●	●	●	●	●	●	●	●	●
10																	●	●	●	●	●	●	●	●	●	●
13																				●	●	●	●	●	●	●

● Combinations available in the eShop | Other sizes on request

All technical data refer to the measure mm

